

## OrthoLine Optical Alignment Cubes

### The Standard for High Precision Alignment Tooling

Jenoptik's OrthoLine optical alignment cubes are designed primarily for processes that require precision datum registration - including applications in the life and health sciences, metrology and defense.

#### Features

- 5 sides polished perpendicular to  $< 2$  arcseconds
- Durable high reflective chome coating
- Sides flt to better than  $\lambda/10$
- High quality fused silica substrates
- Fiducial pattern on 5 sides centered to  $\pm 0.025$  mm



# OrthoLine Optical Alignment Cubes

## The Standard for High Precision Alignment Tooling

### Specification

Size	Unpatterned P/N	Patterned P/N	Dimensions (DIM) "A", "B", "C"
0.50" Cube:	99129ORC0.50	99129ORC0.50P	0.50 inch
0.75" Cube:	99129ORC0.75	99129ORC0.75P	0.75 inch
1.00" Cube:	99129ORC1.00	99129ORC1.00P	1.00 inch

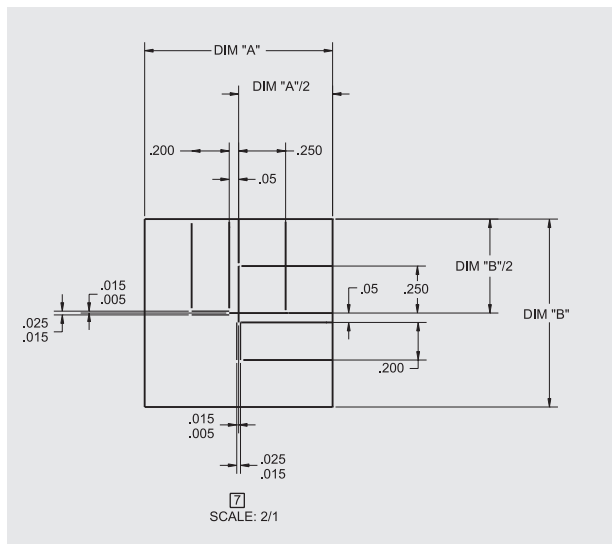

Reticle Dimensions

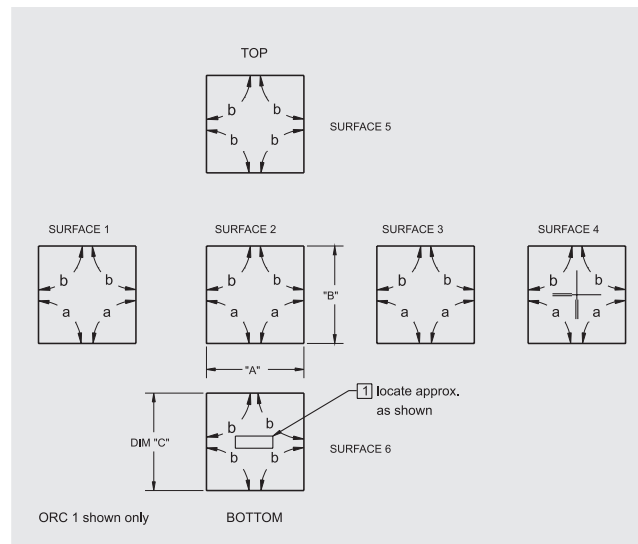

Cube Dimensions

It is our policy to constantly improve the design and specifications. Accordingly, the details represented herein cannot be regarded as final and binding.

